

ASROLL

A Division of  ALBERT SMITH GROUP

COVER FLAT

STANDARD LENGTHS
2.4 metres

PRODUCT CODE
CF

AVAILABLE FINISHES

CODE	FINISH
M	BLACK
G	GALVABOND
H	HOT DIPPED GALV
P	POWDER COAT
S	STAINLESS STEEL
R	SYNTHETIC



TO SUIT WIDTH

75mm
100mm
150mm
225mm
300mm
450mm
600mm

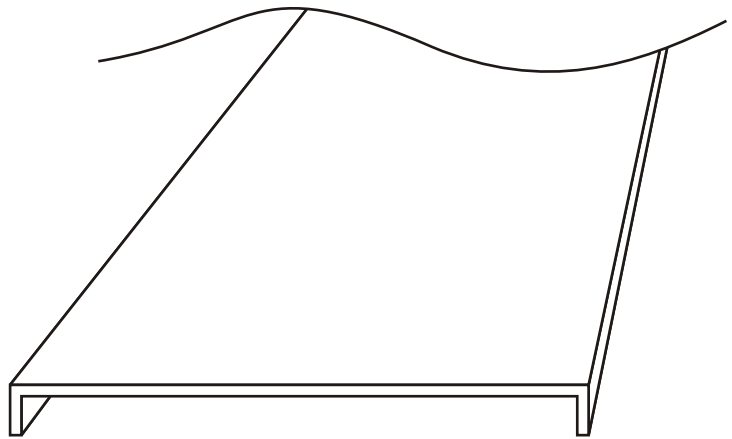

ORDERING CODES An ordering code example is shown below.....

CF150S → **CF** **150** **S**
(Example only) Product Code Required Material Finish
(ie CF for Cover Flat) Width (ie S for Stainless Steel)

COVER PEAKED

STANDARD LENGTHS

2.4 metres

PRODUCT CODE

CP

AVAILABLE FINISHES

CODE	FINISH
M	BLACK
G	GALVABOND
H	HOT DIPPED GALV
P	POWDER COAT
S	STAINLESS STEEL
R	SYNTHETIC

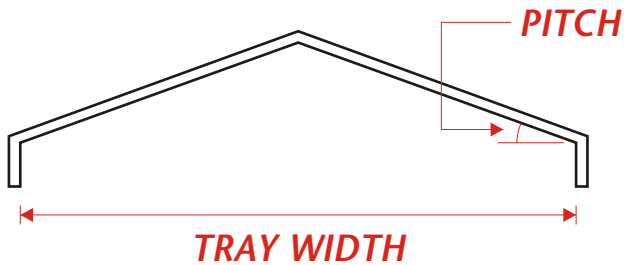

TO SUIT WIDTH

75mm
100mm
150mm
225mm
300mm
450mm
600mm

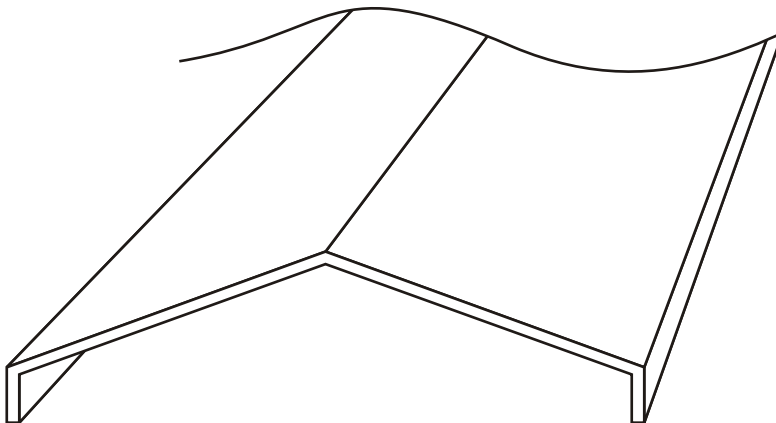

ORDERING CODES

An ordering code example is shown below.....

CP150S
(Example only)



CP

Product Code
(ie CP for Cover Peaked)

150

Required
Width

S

Material Finish
(ie S for Stainless Steel)

ORDER SHEET

AVAILABLE FINISHES

CODE	FINISH
M	BLACK
G	GALVABOND
H	HOT DIPPED GALV
P	POWDER COAT
S	STAINLESS STEEL
R	SYNTHETIC

COVER FLAT

WIDTH REQUIRED _____
 RETURN HEIGHT _____
 No. OF LENGTHS _____

COVER PEAKED

WIDTH REQUIRED _____
 RETURN HEIGHT _____
 No. OF LENGTHS _____

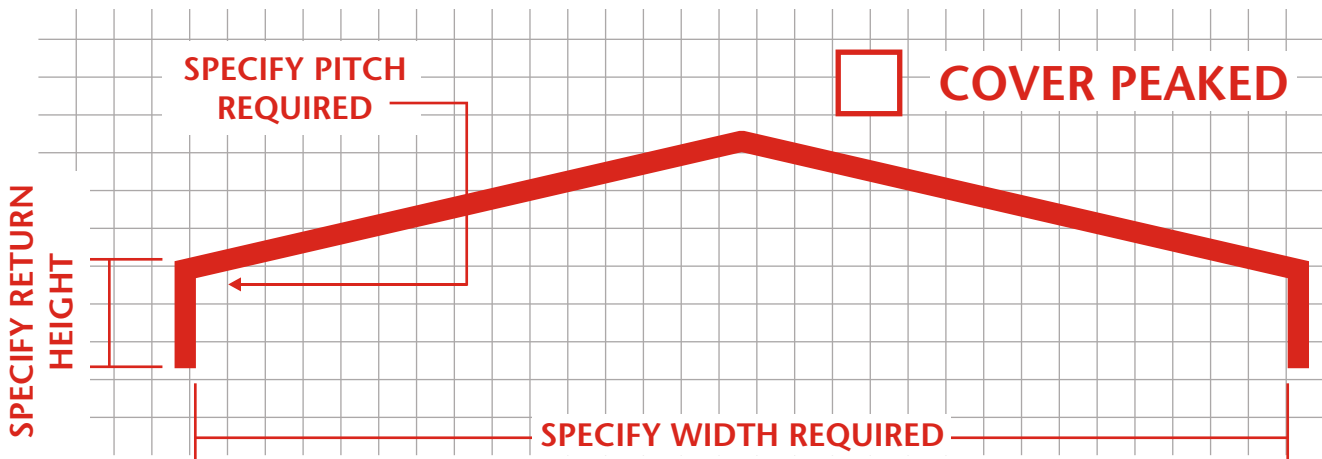
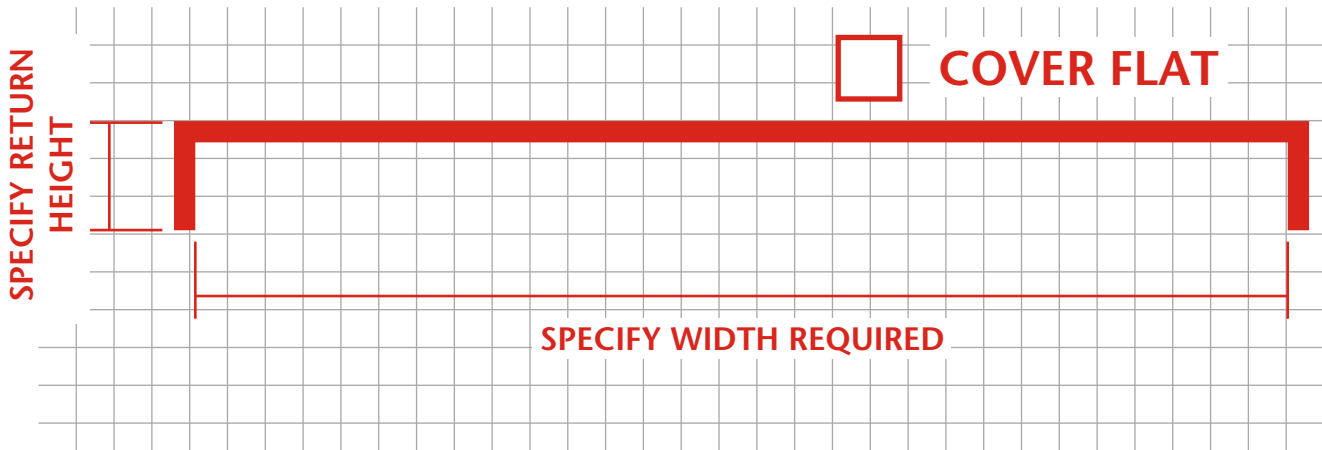

ORDERING DETAILS

CUSTOMER NAME _____ APPROVED (sign below)
 CUSTOMER CONTACT _____
 PROJECT NAME _____

COVER FITTINGS

PRODUCT CODE

C

AVAILABLE FINISHES

CODE	FINISH
M	BLACK
G	GALVABOND
H	HOT DIPPED GALV
P	POWDER COAT
S	STAINLESS STEEL
R	SYNTHETIC

**COVERS FOR ALL TRAY AND
LADDER FITTINGS AVAILABLE
IN ABOVE FINISHES**

ORDERING CODES

An ordering code example is shown below.....

CB312A150H →
(Example only)

C
Fitting Cover Code

B312A150H
*Associated Product Code
(example shown above for 150mm
12A Ladder in Hot Dipped Galvanised Finish)*

COVER ACCESSORIES

AVAILABLE FINISHES

CODE	FINISH
M	BLACK
G	GALVABOND
H	HOT DIPPED GALV
P	POWDER COAT
S	STAINLESS STEEL
R	SYNTHETIC

PRODUCT CODE

CODE	COVER ACCESSORY DESCRIPTION
2240	Plastic End Cap for 40mm x 40mm Strut
4240	Plastic End Cap for 40mm x 20mm Strut
5580	Plastic End Cap for 40mm x 60mm Strut
1184	Plastic Cap for 40mm Strut - 3.0m Length
CC20	Cover Clip - Admiralty Tray
CC50	Cover Clip - Deep Tray and Ladder Tray
CC80	Cover Clip - 12A & 12B Ladder
CC95	Cover Clip - 12C, 16A, 16B, 16C Ladder
CC135	Cover Clip - 20A, 20B & 20C Ladder
CCGP	Cover Clip - General Purpose
LB150	Band - 150mm Tray/Ladder
LB300	Band - 300mm Tray/Ladder
LB450	Band - 450mm Tray/Ladder
LB600	Band - 600mm Tray/Ladder
LBEL	Band - Extra Large Tray/Ladder

ORDERING CODES

An ordering code example is shown below.....

CC80H
(Example only)



CC80
Product Code

H

Material Finish
(ie H for Hot Dipped Galv)